

DaTo

"The Legendary leader of Automotive Equipments"

CWSTS207 / 209 - TUNNEL CAR WASH

Model No : CWTS207 / 209



Advantages

- More productivity due to less wash time.
- Automatically identify vehicle profile.
- Low water consumption.
- Corrosion resistant frame and parts assure longer life span.
- World famous brand electric equipment achieve high stability.

Technical Specifications

Machine Dimension (WxHxL)	3.8m x 3.2m x 10.05m (ss-937)
	3.8m x 3.2m x 10.8m (ss-939)
Max. Vehicle Dimension (W*H)	2.2m x 2.2m
Electricity Supply	3PH AC380V 50Hz
Max. Operating Power	35KW
Estimated Washing Capacity	50 / 60 cars/H
Working Air Pressure	0.6 - 0.8Mpa
Total Power	30.71KW / 31.45KW
Water Consumption	125Liters per vehicle

CONSUMPTION RESULTS ARE OBTAINED UNDER SPECIFIC TEST CONDITIONS FOR REFERENCE ONLY.

Servo Brush Station

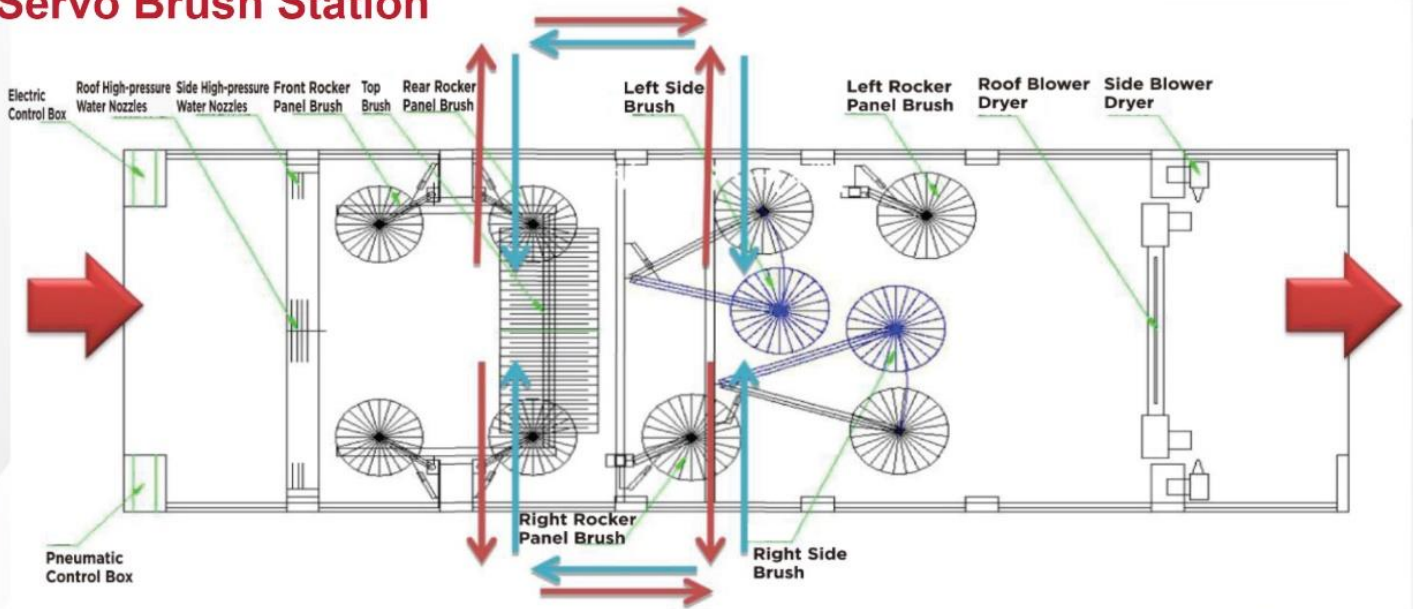

Reinforced column preventing lateral sway

Reinforced C-shaped Steel Column

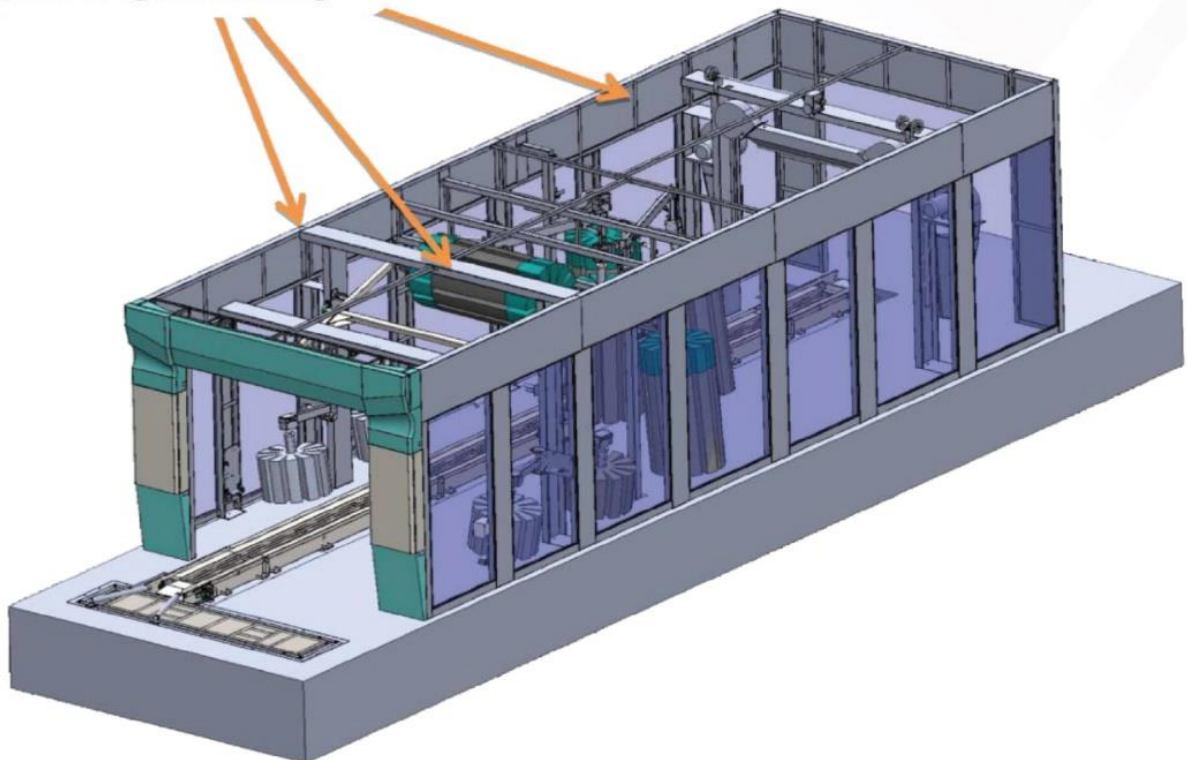

Equipment Details And Accessories



Angled Side Washer

Side brushes automatically tracking car profile and adjust to a certain angle for thorough cleaning from head, body to car tail.



Lifting Top Brush System

Thanks to its auto-identification on different car models, top brush can maximize the cleaning effect from head to tail. Capable of both light-duty or heavy-duty vehicles



Swing High Pressure Water Nozzle

High pressure water nozzles perform well in uniformly rinsing the mud on car surface and prevent scratching, no hurting to car body.



Upper Level Water-Proof motor and Gear Reducer

The motor and gear reducers that we choose for our car washer are high-end products from international/Chinese company, which not only has good water-proof performance but an elegant appearance and long service life

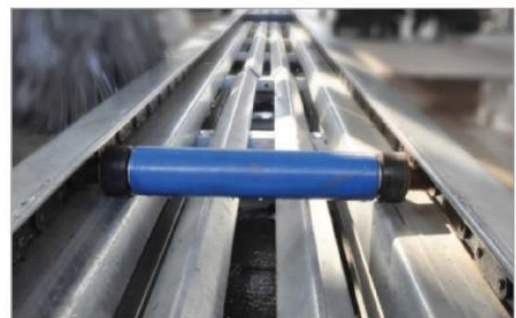

Maintenance-Free Polymer Roller

The conveyor is always the Achilles heel of tunnel car washing system cause it is easy to be rusted away for long-term exposure to mud and waste water. However, thanks to SUS 304 stainless steel roller and nylon material used in the conveyor whose molecular weight is upto 7.2 million, our tunnel car washer perfectly solve this problem.



Side Circulating Swing Brush System

Latest Italian side circulating brush combo can achieve wrap round washing for your car but also give way to those car in case car driver in which mistakenly presses accelerator or brake pedal. The advanced pressure sensing system guarantees pressure balance inn washing process.

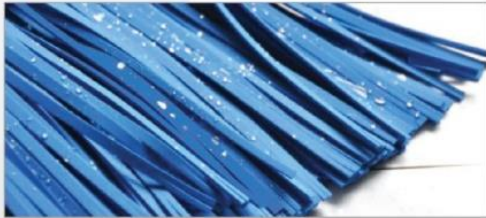

Japanese EVA Foam Brushes

wear-resting and highly durable, Save water due to its waterproof performance and it also do not hold dirt when working on vehicle.

EVA foam are good at working with washing chemicals as its excellent performance on solvent resistance.

Specifications

	ITEM	CWSTS 207	CWSTS 209
Dimension	Machine dimension (W*H*L)	3.8x3.2x10.05m	3.8x3.2x10.08m
	Max.vehicle dimensions (W*H)	2.2x2.2m	2.2x2.2m
Installation	Length	11.65m	12.7m
	Wash bay dimension (L*W)	11.65x3.8m	12.7x3.8m
	Air Pressure	0.6~0.8MPa	0.6~0.8MPa
Power	Total Power	30.71KW	31.45KW
	Max.operating power	35KW	35KW
	Top brush	0.55KWx1	0.55KWx1
	Side brush	0.37KWx4	0.37KWx4
	Rocker panel brush	0.37KWx2	0.37KWx4
	Conveyor	2.2KWx1	2.2KWx1
	Water pump	2.2KWx1	2.2KWx1
	Blower	5.5KWx2 4KWx2	5.5KWx2 4KWx2
	High pressure pump	4KWx1	4KWx1
Swing control motor	0.18KWx3	0.18KWx3	
Other Information	Applicable car models	Sedan,Jeep and cars with less than 7 seats	
	Chemicals	car wash shampoo water wax	car wash shampoo water wax
	Water consumption	125L	125L
	Estimated car washing capacity	50 cars/h	60 cars /h
	Features	self-diagnosis, calculate and overview number of car wash, English version LCD display	

Consumption results are obtained under specific test conditions for reference only.