

# DaTo

"The Legendary leader of Automotive Equipments"

## CWSWL501 - BRUSHLESS AUTOMATIC CAR WASH SYSTEM WITH UNDER WASH SYSTEM



Model No: CWSWL501

DaTo touchless car wash system is powered with a 7.5 HP, Vertical multi stage pump with an output of 66 LPM water and Gear drives and Nozzles with pipe and with PLC program.

Our Automatic Running cycle will be as below, which will be completed in 3.5 Min

1. Full body wash with 22 bar pressure.
2. Foam will be sprayed throughout the car automatically
3. For manual Moping, 45 seconds allowed in the program.
4. Under body will be washed automatically.
5. Followed by Final Body wash @ 22 Bar automatically

Apart from this, Manual modes also available to do all the above operations.

## Features

- The line voltage to the sensor is 24 DC Volts.
- Emergency push button is provided, in case of emergency stop.
- Soft Natural Rubber guards are provided on the moving arms, for vehicle safety.
- This will reduce time, Man power and cost.
- Car is placed stationary and cleaning is done by 14 jet nozzle for body wash and 14 jet nozzle for shampoo.
- Control panel has Automatic as well as manual mode.
- The ULTRASONIC SENSORS are provided to sense automatically the car length.
- All materials exposed to water are made of stainless steel (SS 304).

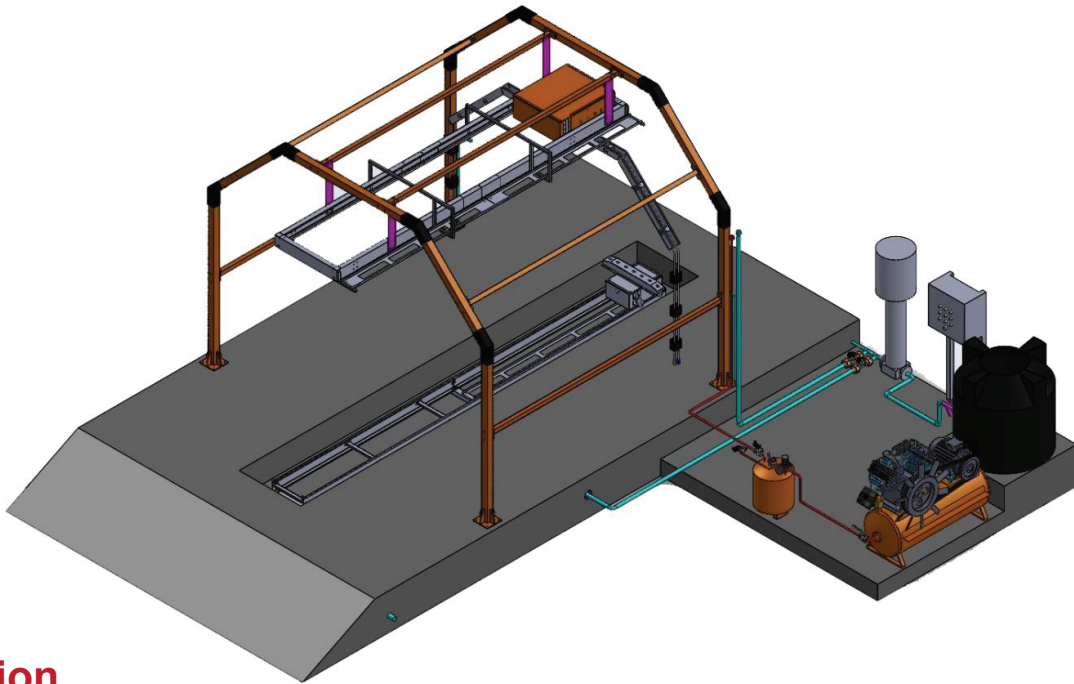

## Specification

PARAMETER	RANGE
Required Space (LxWxH)	6700 x 4250 x 3700 mm
Overall Dimensions	5500 x 3950 x 3080 mm
Max. Washable Dimension of Cars	4750 x 1900 x 1900 mm
Input Supply	3ph, 415v, 50Hz
Connected Load	8Hp
Power Consumption per Car	0.6Units
Water consumption per Car	125Ltr
Shampoo consumption per Car	7ml/Car (Recommended Dilution – 1:700)
Operating Pressure	24 Bar
Made In	India